



Commercial Play Catalog

Version 7.7



Commercial Playground Components

t. 800.663.2803 | www.rtsplay.com

e. info@rtsplay.com



About RTS

RTS Play is a manufacturer/distributor of high quality play components. With over 35 years experience in the playground industry we have exceptionally high standards, unique designs and commitment to safety. We pride ourselves with developing long-standing supplier and customer relationships, providing the most innovative products through quality, service and competitive pricing.

RTS Play's parent company, RTS Companies Inc. is an ISO 9001:2008 certified company. RTS Companies Inc. is a leading manufacturer of plastic playground components across North America.

Safety must come first. All RTS Play's equipment is manufactured to comply with the most current CSA and ASTM standards. RTS Play is a member in good standing with IPEMA, the International Play Equipment Manufacturers Association. Testing and validation is an ongoing process as existing, modified and new products are continuously being tested and certified.

All efforts are made to use the best material and processes available to maximize the longevity of our products. Our molded products are manufactured on computer directed machines using polyethylene resin with the highest UV package in the industry.

We are committed to providing our customers with the highest quality, most durable play equipment backed by an extensive warranty, qualified sales and engineering team and dedication to customer service.

Products and Services

- Drawings and Specifications
- Quality Control - Quality Assurance
- Molded-in Inserts and Graphics
- Assembly
- Spin Welding
- U.L., U.N., C.S.A. Certification



RTS Commercial Play

Table of Contents

Page 2-5	Company Profile
Page 6-12	Tube Components
Page 13	Unions & Vessels
Page 14-17	Slides
Page 18	Roofs
Page 19	Platforms
Page 20	Climbers
Page 21	Commercial Hardware
Page 22	Borders
Page 23	Landscape Rocks



Component Orders

Please refer to the part number and color number shown on the price list. Designation by part and colour number on your purchase order will help minimize confusion and assure your order is filled properly.

Example: Part No. 7510-030000-01-00 designates a Red 30" x 30 deg Elbow

Color
01
Material
00
Product 003000X where X can be any alphabet

Orders may be sent via:

Mail:

RTS Companies US Inc.
2900 Industrial Park Drive
Austinburg, Ohio
USA 44010-0183

RTS Companies Inc.
1027 Industrial Place
St. Clements, Ontario
Canada N0B 2M0

Phone:

1.888.641.3077 (USA) | 1.800.663.2803 (Canada)

Email:

info@rtsplay.com

Fax:

1.519.699.0027

Please include your desired shipping date, contact person and telephone number should we have any questions.

Terms of Sale

All sales are Net 30 days, Austinburg, Ohio or St. Clements, Ontario subject to RTS Standard Terms and Conditions.

Establishment of account on or above terms is subject to verification of credit. A credit application will be forwarded to you upon request. Credit verification usually requires one week.



RTS Commercial Play

2022 Color Selection Chart - Effective Jan. 1st, 2022

RTS Standard Colors

RTS Standard Colors comprise our “in-stock” inventory program. Components, unless otherwise noted are available in Standard Colors.

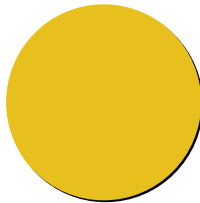

JB YELLOW
#1000

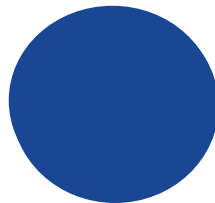

BLUE
#3100

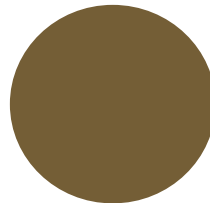

OAK
#5400

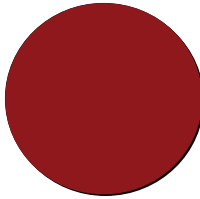

RED
#0100

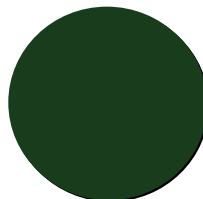

FOREST GREEN
#2900

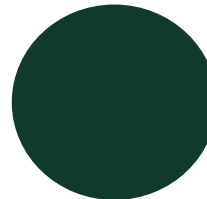

KTKY. GREEN
#4200

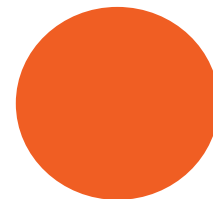

ORANGE
#6400

RTS Secondary Colors

RTS Secondary Colors are available on orders with a minimum of 10 pieces of the same color per order. Smaller orders are subject to review and additional surcharges may apply. Please contact RTS customer service for details or to receive a quote.



LT. TEAL
#3500

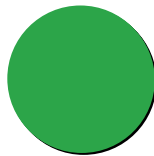

SPRING GREEN
#6300

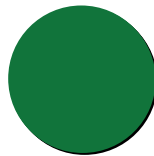

STD. GREEN
#4900

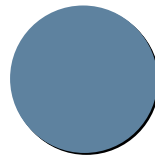

SKY BLUE
#3300

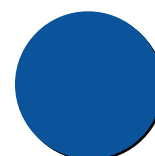

PACIFIC BLUE
#3800

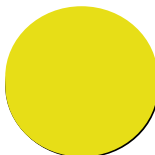

RTS YELLOW
#6200



PURPLE
#2700

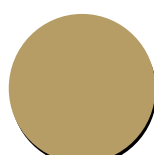

TAN
#5100

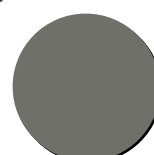

GREY
#7000

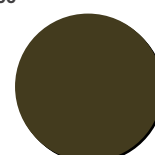

MUD
#5600



***SANDSTONE**
#6830

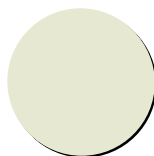

***WHITE**
#8800

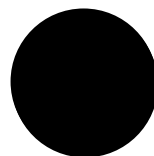

***BLACK**
#8000

* Additional color upcharge.
Please obtain quote before ordering.

Sandstone, White and Black are not suitable for all RTS Commercial Play products.

Please consult RTS customer service for additional information.



24" Tube Components

Straight Tubes

24" Diameter Components

Straight Tube

Dimensions: 24" x 86"

Part No. 7505-52486T-XX-00



Entry Panels

24" dia. Entry Panel

Dimensions: 40.5" x 40.5" x 3"

Part No. 7500-24001T-XX-XX



24" dia. x 3" Flat Entry Panel

Dimensions: 31" x 39" x 3"

Part No. 7500-24002T-XX-XX





30" Tube Components

Straight Tubes

30" Diameter Components



Single Bell Straight Tube

Dimensions: 30" dia. x 48

Part No. 7505-03048T-XX-XX



Single Bell Straight Tube

Dimensions: 30" dia. x 72 1/4"

Part No. 7505-03072T-XX-XX



Double Bell Straight Tube

Dimensions: 30" dia. x 96

Part No. 7505-03096T-XX-XX

Entry Panels



30" dia. x 3" Flat Entry Panel - Bell End

Dimensions: 41" X 43" X 3"

Part No. 7501-30003T-XX-XX



30" dia. x 3" Flat Entry Panel - Non Bell End

Dimensions: 41" X 43" X 3"

Part No. 7500-03004T-XX-XX



30" dia. Raised Entry Panel

Dimensions: 41" X 41" X 7"

Part No. 7501-30000T-XX-XX



Tube Components

Elbows

30" Diameter Components



45 deg Long Sweep Elbow

Dimensions: 30" dia. x 45 degree
Part No. 7520-03000T-XX-XX



30 deg Elbow

Dimensions: 30" dia. x 30 degree
Part No. 7510-03000T-XX-XX

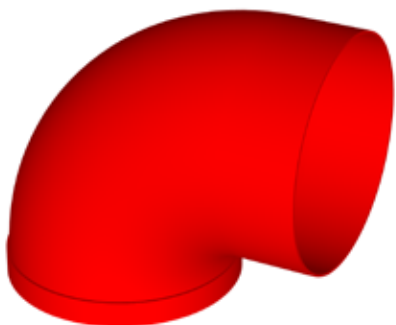

90 deg Elbow

Dimensions: 30" dia. x 90 degree
Part No. 7525-03000T-XX-XX



Tube Components

Elbows

30" Diameter Components

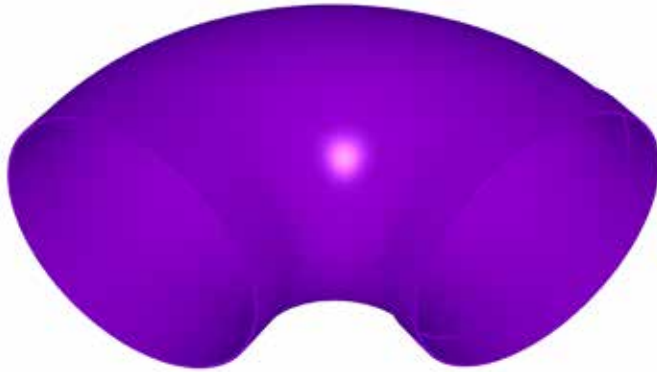

112 deg Elbow

Dimensions: 30" dia. x 112 degree
Part No. 7530-03000T-XX-XX



Longsweep Elbow

Dimensions: 30" dia. x 30 degree
Part No. 7515-03000T-XX-XX



30" dia. Exit Chute

Dimensions: 30" dia. x 41"
Part No. 7535-03000T-XX-XX



Tube Components

Custom Tubes



30" Diameter Crawl Tube Assemblies

Dimensions: 30" dia. x 36"

Part No. for NON-BELL FLAT
7701-93003A-XX-XX

Dimensions: 30" dia. x 48"

Part No. for RAISED
7701-83004A-XX-XX
for NON-BELL FLAT
7701-93004A-XX-XX

Dimensions: 30" dia. x 60"

Part No. only RAISED
7701-83006A-XX-XX

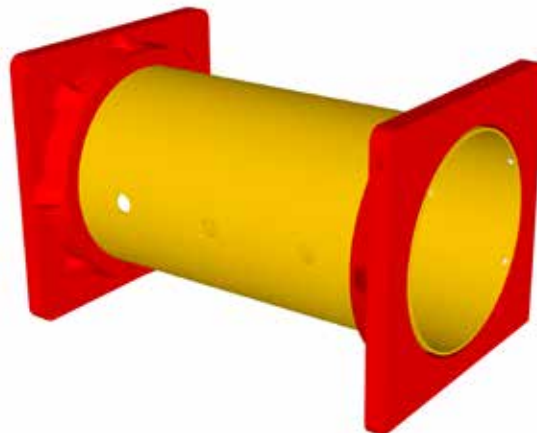



Tube Components

Tube Accessories

30" Diameter Components

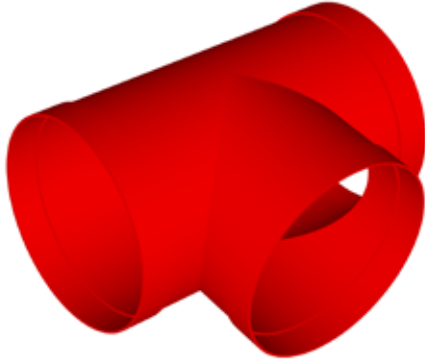

T-Tube

Dimensions: 30" dia.

Part No. 7540-03003T-XX-XX

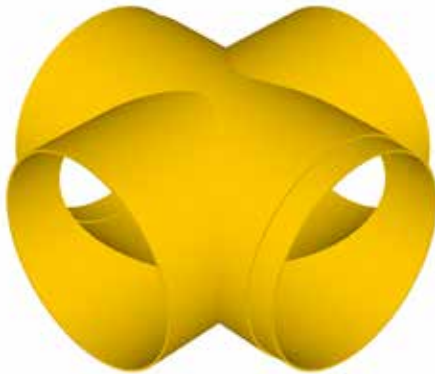

4-Way Intersection

Dimensions: 30" dia.

Part No. 7545-03004T-XX-XX



Curved Tube Flange

Dimensions: 30" dia.

Part No. 7545-03004T-XX-XX

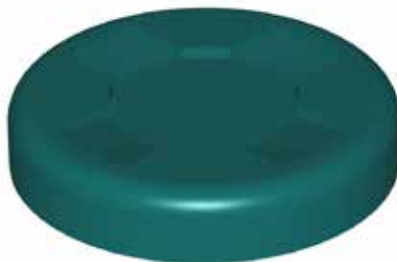

End Cap

Dimensions: 30" dia.

Part No. 7555-00004T-XX-XX



Tube Components

Tube Accessories



Junction Box w/ Bell Top

Dimensions: 30" dia.

Part No. 7552-03005T-XX-XX



Junction Box Flange

Dimensions: 30" dia.

Part No. 7550-03001T-XX-XX

* Sold as a set of 3 only



30" Junction Box

Dimensions: 30" dia.

Part No. 7550-03004T-XX-XX



3-Way Junction Box

Dimensions: 30" dia.

Part No. 7551-03003T-XX-XX



Unions & Vessels

Unions



Tube Diameter Spherical Union

Dimensions: 30 3/4" dia.

Part No. 7565-03002T-XX-XX

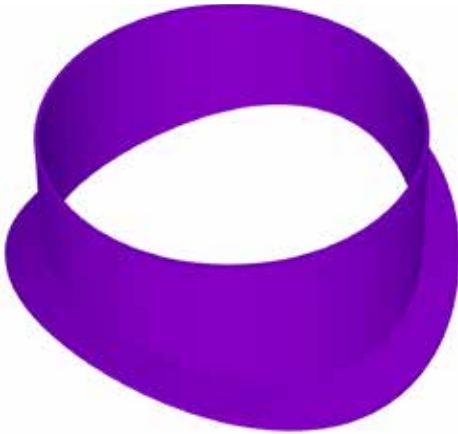

Tank Vessel Union

Dimensions: 30 3/4" dia.

Part No. 7565-03002T-XX-XX

* Sold as a set of 2 only

Vessels

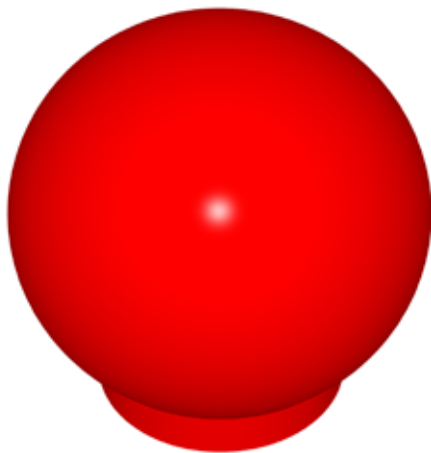

Spherical Vessel

Dimensions: 48" dia. w/ 30" flange

Part No. 7570-04800T-XX-XX



Slides

6' Flare Spiral Slide



- | | | |
|-------------------------------------|----------------------------|---|
| A. Flare Spiral Slide | Part No. 7042-76200A-XX-00 | (Includes hood, post and hardware) |
| B. Flare Spiral Hood | Part No. 7042-06102T-XX-00 | |
| C. Flare Spiral Side Entry Panel | Part No. 7042-06103T-XX-00 | (sold individually- requires 2 per slide) |
| D. Spiral Slide Deck Support | Part No. XXXX-XXXXXX-XX-XX | (recommended deck support) |
| E. Spiral Slide Center Pole | Part No. 7042-04512B-99-25 | (12' sold unpainted) |
| F. Hardware Kit | Part No. 7042-76200K-00-00 | |
| G. Flared Slide Universal Foot Buck | Part No. 6510-00024K-00-00 | |



Slides

Flare Slides



Flare Extra Wide Slide

Dimensions: 3' Deck Height
Part No. 7061-03101T-XX-XX



Flared Slide Universal Foot Buck
Part No. 6510-00024K-00-00

Misc. Slides



Triple Rail Straight Slide

Dimensions: 3' - 4' Deck Height
Part No. 7016-03101T-XX-XX*

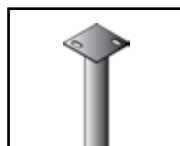

Double Slide Foot Buck
Part No. 6510-00034K-00-00
*Requires 2 Foot Bucks



Slides

Slide Hoods



Single Slide Hood

Dimensions: 39 1/2" x 45"

Part No. 7100-00101T-XX-XX



Triple Rail Slide Hood

Dimensions: 42 1/4" x 41"

Part No. 7105-00101T-XX-XX



Tube Slides

Custom Tube Slides

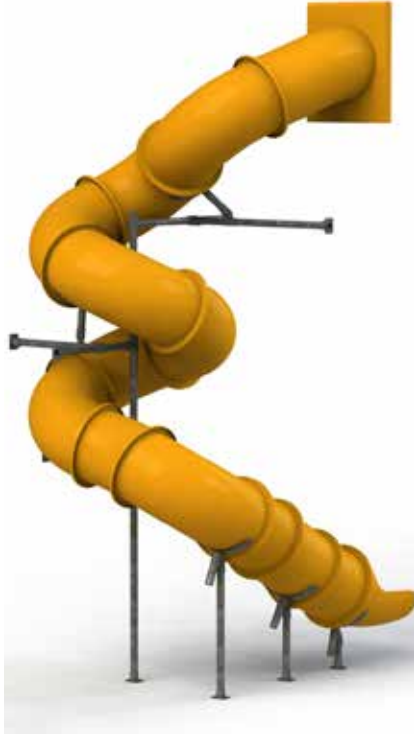

Sometimes your projects call for unique twists on traditional tube slides.

RTS Companies has proudly designed hundreds of custom tube slides for commercial and residential applications accross North America.

Never duplicated, our custom tube slides are made to fit your specs, with ongoing support from our team of engineers and project managers along the way.

RTS Slides have been installed in adventure centres, in homes, on boats, in pools and throughout playgrounds across North America.

Standard Tube Slides



Standard Dimensions:

30" Diameter x 48" Straight	Part No. 7705-x3004A-XX-XX
30" Diameter x 60" Straight	Part No. 7705-x3005A-XX-XX
30" Diameter x 72" Straight	Part No. 7705-x3006A-XX-XX
30" Diameter x 96" Straight	Part No. 7705-x3008A-XX-XX

Available with supports and without supports.



Roofs

Unique & Traditional



One Piece Ribbed Hex Roof

Dimensions: 8' x 8'

Part No. 7317-00101T-XX-XX



Traditional Ribbed Roof

Single Wall

Dimensions:

60" x 60" x 25.5

Part No.

7300-00002T-XX-00

Double Wall

Dimensions:

60" x 60" x 25.5

Part No.

7305-00002T-XX-XX

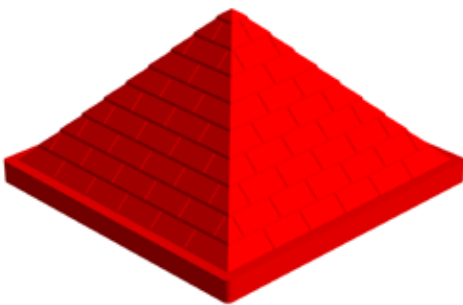

Traditional Shingle Roof

Single Wall

Dimensions:

48" x 48" x 31.5"

Part No.

7300-00001T-XX-00

Double Wall

Dimensions:

48" x 48" x 31.5"

Part No.

7305-00001T-XX-XX



Platforms

Square & Triangle

Square Platform

Dimensions: 48" x 48" x 3"
Part No. 7580-04844T-XX-XX

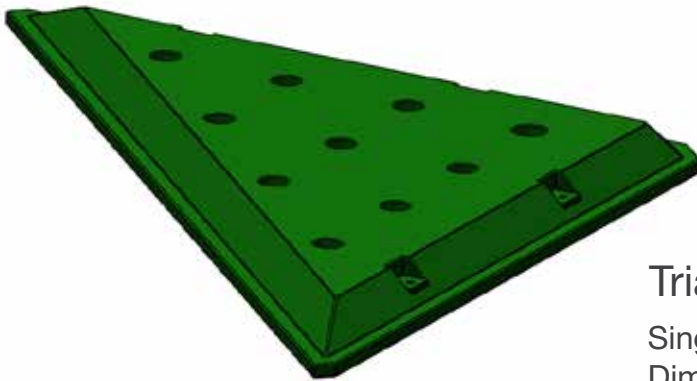
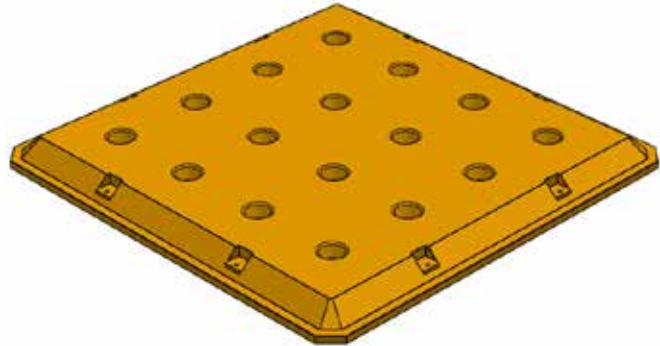

Triangle Platform

Single Wall
Dimensions:
65.5" x 34" x 3"
Part No. 7575-02452T-XX-XX



Climbers

Rock Climbing Wall



Real Life Rock Climbing Experience

Bone & Fossil Imprints on Back Side of Unit

Available in 57" Deck Height

Polyethylene Construction



Back View

Part No. 7200-06057T-XX-XX

Dimensions: 42"W x 57"H x 12"D



Commercial Hardware

Hardware



Tube Joint Set
Part No. 7995-00010K-00-00



Saddle - Black Only
30" Part No. 6510-00008Z-80-00



Standard Saddle Mounting Hardware Kit
Part No. 7995-00011K-00-00



Panel Joint Kit
Part No. 7995-00012K-00-00



Build it in minutes - looks like real stone!



- Wall height options: 10" or double stacked 20"
- Durable, granite-look plastic with secondary finish
- Each module weighs only 9 pounds
- 10 year UV stabilized HDPE

Straight Section No Spike

Dimensions: 48" x 10"

Part No. 5506-00100A-00-00



Curved Section No Spike

Dimensions: 30" x 10"

Part No. 5506-00200A-00-00



3-End Rocks

Dimensions: 6" x 6"

w/18" Spike

Part No. 5506-00310A-00-81

w/28" Spike

Part No. 5506-00320A-00-81



28" Galvanized Spike

Part No. 5506-00103B-00-28

18" Steel Spike Raw

Part No. 5506-00102B-00-25





Landscape Rocks

Polyethylene Landscape Rocks



Left Triangle

Dimensions: 36"L x 27"W x 14"H
Part No. 5620-00101T-XX-XX



Right Triangle

Dimensions: 36"L x 27"W x 14"H
Part No. 5621-00101T-XX-XX

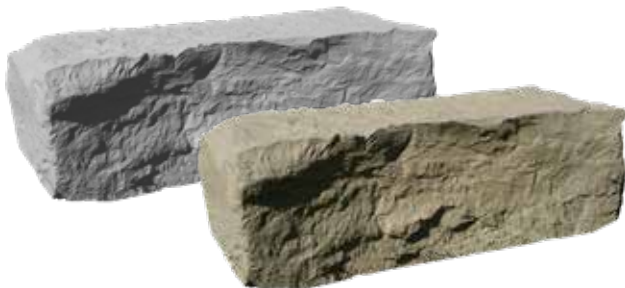

Large Rock

Dimensions: 42"L x 17"W x 13"H
Part No. 5622-00101T-XX-XX



Extra Large Rock

Dimensions: 42"L x 34"W x 13"H
Part No. 5623-00101T-XX-XX



Side Profile



Top Profile



GRAY / ARMOR STONE

OAK / ARMOR STONE

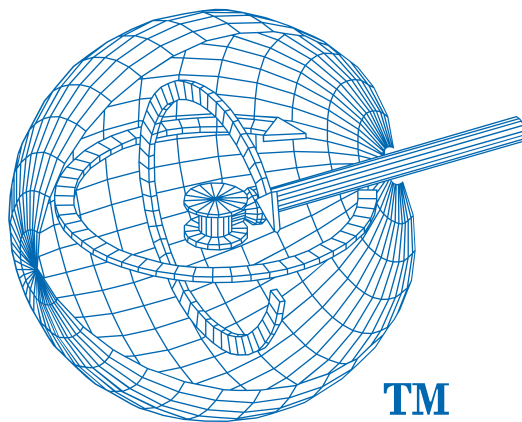

TM

RTS

